



Shell Creek Addition

Lakeview Community Schools

Dr. Aaron Plas

AGENDA

- ▶ Shell Creek History
- ▶ Proposal
- ▶ Why Shell Creek?
- ▶ Construction
- ▶ What about Platte Center?
- ▶ Questions?

SHELL CREEK HISTORY

- ▶ Original District 10 Building was built in 1969
 - ▶ One Teacher per Multiple Grades
- ▶ 1998 - District 10 Became Part of K-12 LCS System
- ▶ 2011 - \$5.0 Million Dollar Bond Passed to Renovate/Add to Shell Creek Elementary
 - ▶ Student Population of 183 in 2011
- ▶ 2012 - Remodel/Addition to Shell Creek Completed
 - ▶ Created Two Track Elementary School (Two teachers per grade)
- ▶ 2020 - Student Population of Over 300 Exceeding Capacity 3 of last 5 Years

The image features a top-down view of several rolled-up architectural blueprints resting on a light-colored wooden surface. The blueprints are partially unrolled, revealing detailed technical drawings with various lines, dimensions, and alphanumeric labels. The background is a light blue gradient with abstract, overlapping geometric shapes in various shades of blue, creating a modern and professional aesthetic. The word 'PROPOSAL' is centered in the right half of the image in a large, bold, blue sans-serif font.

PROPOSAL

CLASSROOM ADDITIONS

- ▶ Six larger primary classrooms (PK-3rd Grade) to the east of current facility be constructed during the 2021-22 school year
- ▶ Operational in August of the 2022-23 school year
- ▶ Classroom Plans
 - ▶ Six classrooms used for the following:
 - ▶ Preschool Room - Morning/Afternoon Session
 - ▶ Kindergarten Room - 3rd Track
 - ▶ 1st Grade Room - 3rd Track
 - ▶ 2nd Grade Room - 3rd Track
 - ▶ 3rd Grade Room - 3rd Track
 - ▶ Future Expansion Open Room

ANTICIPATED STAFFING

- ▶ 2022-23 School Year (Depending on class size and need)
 - ▶ Preschool, Kindergarten, and 1st Grade teacher
 - ▶ 2/5th Time Physical Education Teacher
 - ▶ Necessary for scheduling purposes due to shared staff between Shell Creek and Platte Center
- ▶ 2023-24 School Year (Depending on class size and need)
 - ▶ 2nd Grade and 3rd Grade teachers

WHY SHELL CREEK?

The background features a series of overlapping, semi-transparent geometric shapes in various shades of blue, ranging from light sky blue to a deep navy blue. These shapes are primarily triangles and quadrilaterals, creating a dynamic, layered effect. The shapes are positioned on the right side of the frame, extending towards the center, while the left side remains mostly white.

ENROLLMENT TRENDS

- ▶ Five Year Enrollment Totals (November 1st)
 - ▶ Building capacity is listed as 300 students
 - ▶ 2020 - 318 (106.0% capacity)
 - ▶ 2019 - 324 (108.0% capacity)
 - ▶ 2018 - 285 (95.0% capacity)
 - ▶ 2017 - 282 (94.0% capacity)
 - ▶ 2016 - 302 (100.6% capacity)
- ▶ Primary Grades Average Class Size Last Four Years
 - ▶ Kindergarten Four Year Average - 40.25 (20 per class)
 - ▶ Four of eight total sections over 22 students
 - ▶ 1st Grade Four Year Average - 40.50 (20 per class)
 - ▶ Three of eight total sections over 22 students
 - ▶ 2nd Grade Four Year Average - 40.50 (20 per class)
 - ▶ Two of eight total sections over 22 students
 - ▶ 3rd Grade Four Year Average - 43.25 (22 per class)
 - ▶ Five of eight total sections over 22 students

FUTURE

▶ Five Year Estimates/Growth

▶ Five Year Rolling Average Estimates

- ▶ 415 - Building Enrollment estimate for 2025-26 school year

▶ School/Community Growth

- ▶ Currently around 100 housing lots for sale in the district
- ▶ Lakeview Community Schools has grown over 30% in 7 years

▶ Potential Future Construction at Shell Creek

▶ Finalize third track of classrooms

- ▶ Add additional common space to accommodate for PE, recess, lunch, after school program.

The background features a series of overlapping, semi-transparent geometric shapes in various shades of blue, ranging from light sky blue to a deep, dark navy blue. These shapes are primarily triangular and polygonal, creating a dynamic, layered effect. The shapes are positioned on the right side of the frame, extending towards the center. The overall aesthetic is clean, modern, and professional.

CONSTRUCTION

CONSTRUCTION TIMELINE

- ▶ August 2021 - Gather Staff/Community Feedback
- ▶ October 2021 - Final Proposal Goes to Board of Education
- ▶ November 2021 - Construction Manager and Architect Selected
- ▶ January 2022 - Construction Plans Finalized and Approved
- ▶ March 2022 - Construction Begins
- ▶ August 2022 - Construction is Finalized

CONSTRUCTION COSTS/PAYMENT

▶ Construction Cost

- ▶ Estimates will be provided by Architects and Construction Manager after the final proposal is approved by the Board of Education.

▶ Payment of Construction Using Special Building Funds

- ▶ Because of available Special Building funds this construction project will NOT need to sell bonds, and will NOT add to the levy
- ▶ Lakeview Jr./Sr. High project came in \$1.2 million under budget creating additional funds

SHELL CREEK SCHOOL MAP

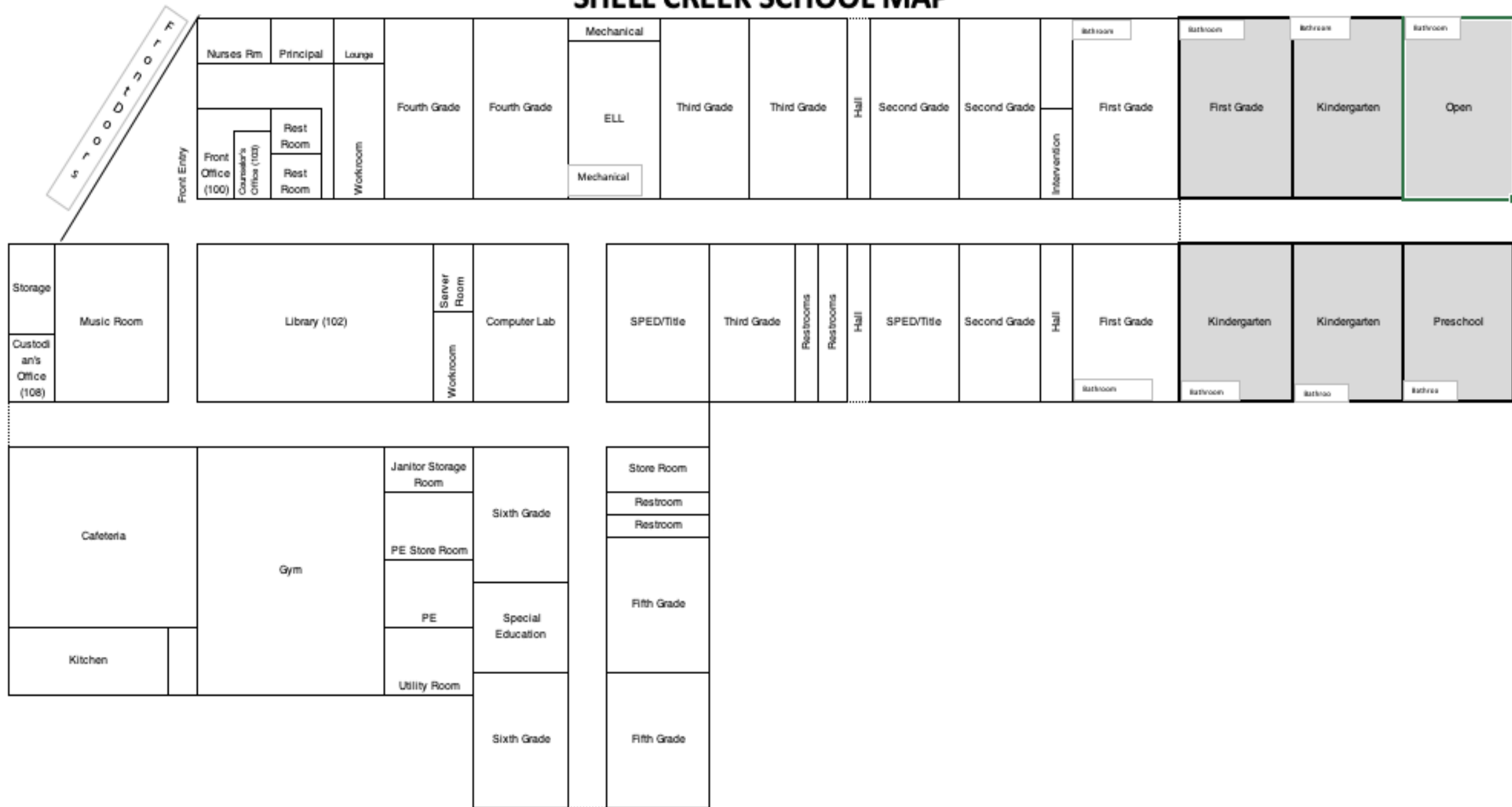

WHAT ABOUT PLATTE CENTER ELEMENTARY?

- ▶ Will this shut down or impact Platte Center elementary?
 - ▶ No, Platte Center Elementary is a valuable school in our district and this addition will not have any negative impact on Platte Center Elementary. Platte Center has averaged 91.66% capacity for the past six years. The five year rolling average forecasts the enrollment at Platte Center to increase 1.84% or 131 students.
- ▶ Will this addition change the number of students at Platte Center Elementary?
 - ▶ No, Platte Center Elementary boundaries will remain the same. Students receiving school transportation will continue to be spread out over the buildings and classes to get the enrollments as even as possible.
- ▶ Will the preschool at Platte Center stay open?
 - ▶ Yes, the preschool at Platte Center will stay open. The preschool at Shell Creek will be in addition to Lakeview Community Schools.
- ▶ What about updating of Platte Center's building?
 - ▶ Lakeview Community Schools takes pride in all of their facilities, and that includes consistent updating of Platte Center Elementary. For the previous three years a classroom as has been updated and this will continue into the future. In addition, large scale project such as remodeling the gym and updating the roof have taken place of the last two years. The Board of Education has made a long-term commitment to the building.

QUESTIONS & FEEDBACK

- ▶ Find all of the information on the Shell Creek Addition on the district website
- ▶ For Questions or Feedback - contact Dr. Aaron Plas
 - ▶ Email - aplas@lakeview.esu7.org
 - ▶ Phone - (402) 564-8518